



RESIDENTIAL AND COMMERCIAL
WINDOW AND DOOR SPECIALISTS

GATEWISE METALS

GW50&86

RESIDENTIAL GRADE SERIES

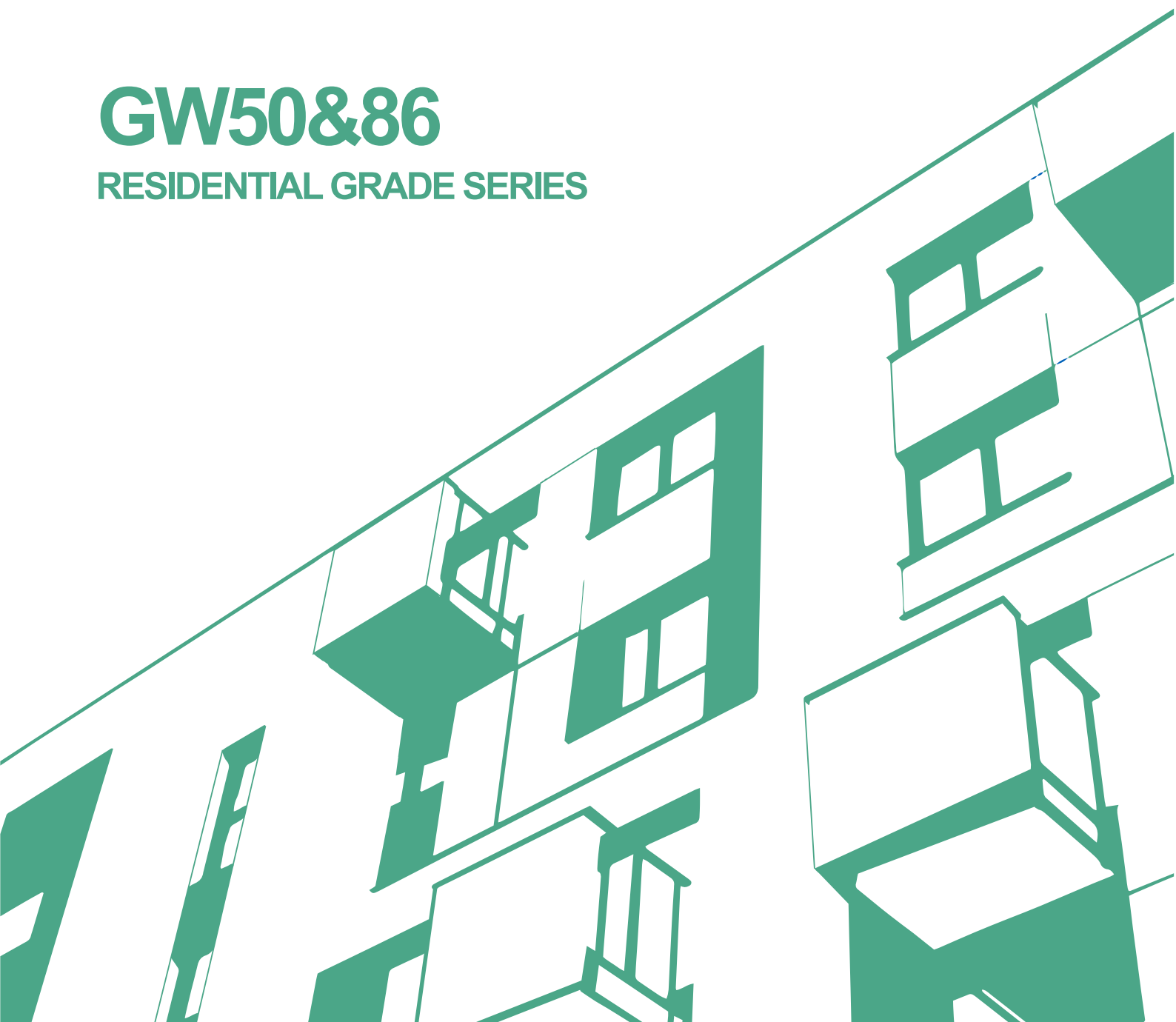

PRODUCT CATALOG

GW50 FIXED WINDOW	01
GW50 AWNING WINDOW	05
GW86 SLIDING WINDOW	09
GW86 AWNING WINDOW	13
GW86 FIXED WINDOW	17
GW86 DOUBLE HUNG WINDOW	21
GW86 GLASS LOUVRE	25
GW86 SLIDING DOOR	29
GW68 BIFOLDING DOOR	33
FLYSCREEN SELECTIONS	37
GLASS SELECTIONS	38
FIXING METHOD	39
FINISHING:POWDER COATING	41
OUR SUPPLIERS	42
GW WINDOWS ORDERING FLOWS	43
PROJECTS COLLECTION	44



About

Us

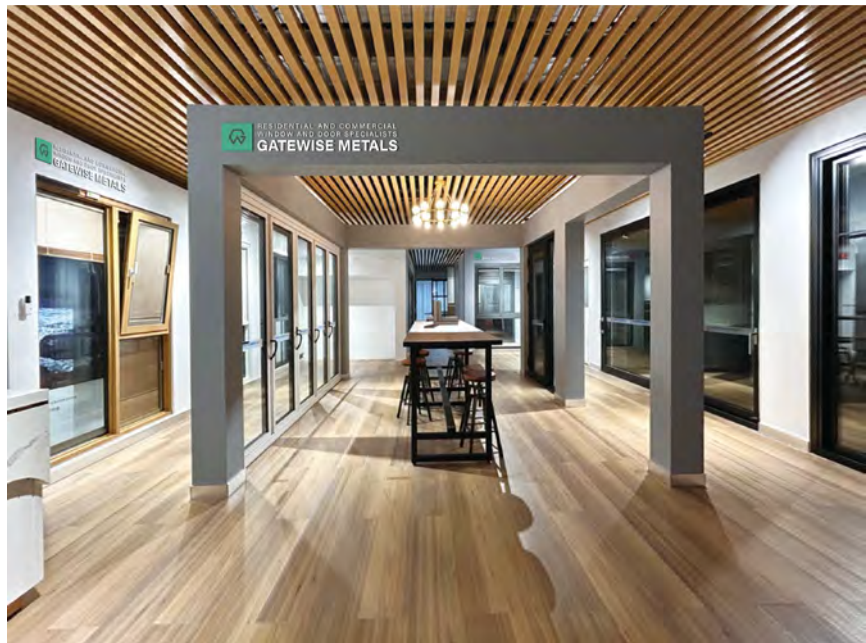

Gatewise Metals P/L is one of the most experienced Suppliers of aluminium windows&doors, Our products comply with AS2047, AS1288, AGWA, WERS certificates .

We specialize in providing you with creative and diverse residential and commercial window and door solutions to help you build your dream home.

Our parent company for over 35 years has provided Quality,Value & Service plus has set the benchmark in the building industry and enjoyed high reputation in the market.

Our aim is to provide the best value to the people we serve. We achieve this by providing guidance, expertise, and commitment to assist you with compliant installations. We have a continuous improvement culture that focuses on delivering a better product & service at a higher quality, quicker lead-time and at a competitive price. Our delight is to give you confidence and peace of mind.

Established in 1990, we attribute much of our success to many people we serve and dedicated business partners who have the same core principles of trust and integrity. As members of the Australian Window Association, you can be confident that our products have been tested in WERS Window Energy Rating Scheme and comply with Australian Standards AS2047 & AS1288.

We are looking forward to being of service and supplying high quality products to you!



COMPANY CERTIFICATES



AUSTRALIAN
**GLASS &
WINDOW**
ASSOCIATION

2025 CERTIFICATE OF MEMBERSHIP

THIS IS TO CERTIFY THAT

GATEWISE METALS

MEMBER NUMBER **38110**

is a current member of AGWA Limited and undertakes
to abide by the AGWA Constitution and Code of Ethics.

Dean Haritos

Chairperson

[Signature]

Executive Director & CEO



7 Ronald Ave Ryde



4 Daffodil St Eastwood



GW50 AWNING WINDOW SERIES



GW50 Awning Window

As the awning window chain winder is located on the sill, these windows can be positioned higher up along the wall to limit anyone being able to see in, whilst still allowing in all the fresh air and natural light. Alternatively, if this type of window is used in a bathroom, using an obscure glass allows you to use this window for ventilation while still getting all the benefits of the privacy glass.



GW50 AWNING WINDOW SERIES



Standard: AS2047

Design SLS / ULS: 600Pa/900Pa

Design Water Resistance: 300Pa

WERS Data: U_w Range: 6.0 – 3.5

SHGC Range: 0.25 – 0.5

Sound Insulation: 32DB



GW50 AWNING WINDOW SERIES

TECHNICAL SPECIFICATIONS

Extrusion Profiles: 6063-T5 with 1.4mm Thickness

Flynet: Stainless Steel Security Mesh Available

Available Size: Frame Height: 450mm~2400mm;
Frame Width: 450mm~2400mm
Window Panel Height: 400mm~1800mm;
Window Panel Width: 400mm~2100mm

Available Glazing: Single/Double Glazed: up to 24mm IGU

Frame Dimension: Frame Depth: 50mm; Bottom Frame Height: 40mm

Fixing Method: Timber Reveal

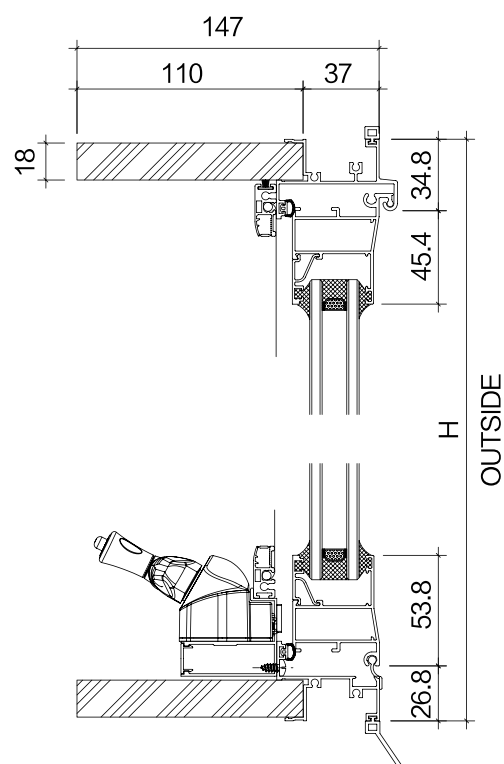



GW50 AWNING WINDOW SERIES

Hardware Selection:

1. Brand: Doric

2. Origin Country: Australia

3. Model: DS1-Chainwinder

4. Color: Black, Silver, White, Custom

Feature:

Window restriction compliant in association with Kids don't fly with an easy chain restrictor switch
Removable chain from sash plate for easy and reduced installation time - Easy Link
Smooth, effortless operation and control for large awning openings
Fold down lever with adjustable spline

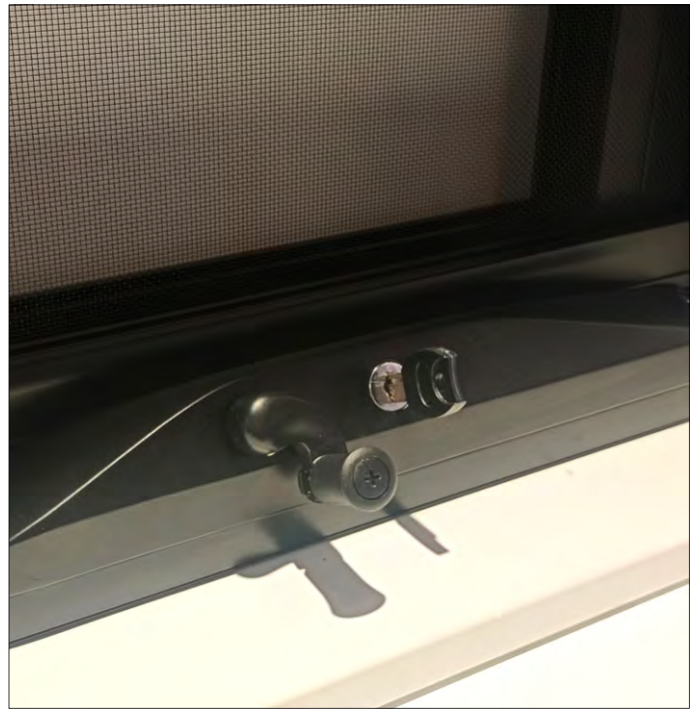

Strengthening Measures:

Use Aluminum Angle to fix the connection of timber reveal.

Benefits:

1. Makes the whole window stronger.

2. Damage to doors and windows will also be reduced during handling.





GW50 FIXED WINDOW SERIES



GW50 Fixed Window

A fixed window is a window that cannot be opened because it is generally glazed directly in the frame, or the sash is fixed to the window frame. They are used only for light and for overlooking. Usually used in aisles, stairwells. The fixed window is the most energy efficient window type, with good water and air tightness. They can also be designed as skylights, aisle windows etc. to create a building appearance full of character and are widely used in all types of buildings.



GW50 FIXED WINDOW SERIES



Standard: AS2047

Design SLS / ULS: 600Pa/900Pa

Design Water Resistance: 4500pa

WERS Data: U_w Range: 5.5 – 3.0

SHGC Range: 0.25 – 0.5

Sound Insulation: 32DB



GW50 FIXED WINDOW SERIES

TECHNICAL SPECIFICATIONS

Extrusion Profiles: 6063-T5 with 1.4mm Thickness

Flynet: Stainless Steel Security Mesh Available

Available Size: Frame Height: 450mm~2400mm;
Frame Width: 450mm~2400mm
Window Panel Height: 400mm~1800mm;
Window Panel Width: 400mm~2100mm

Available Glazing: Single/Double Glazed: up to 24mm IGU

Frame Dimension: Frame Depth: 50mm; Bottom Frame Height: 40mm

Fixing Method: Timber Reveal

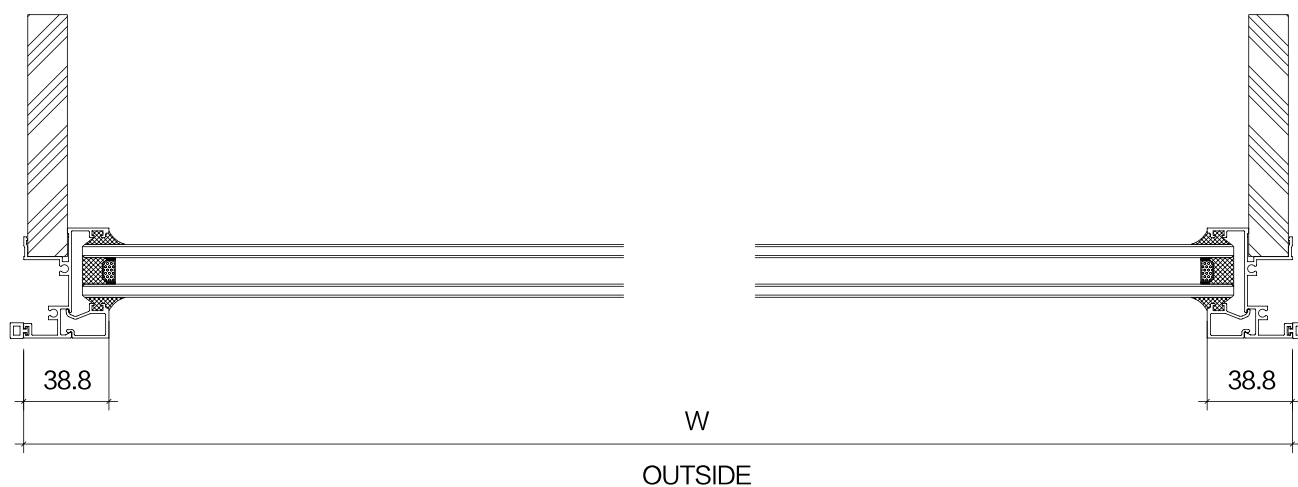
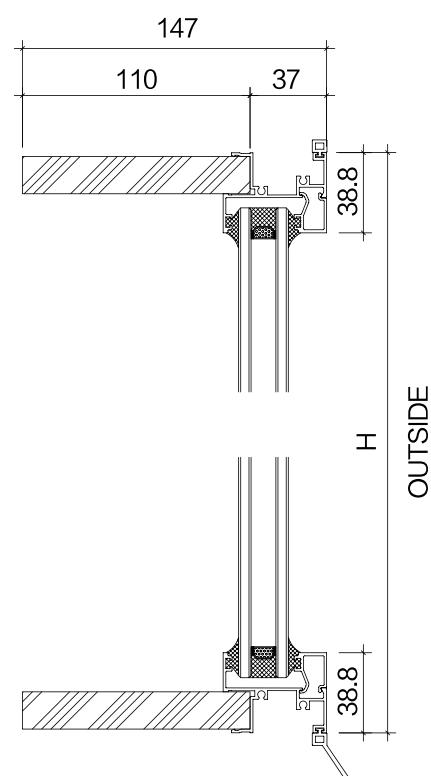



GW50 FIXED WINDOW SERIES





GW86 RESIDENTIAL SERIES



GW86 SLIDING WINDOW

Much like sliding doors, sliding windows open horizontally, by sliding along rails. Sliding windows are easy to use, low maintenance, and economical. Sliding windows also offer the possibility of having very large windows which can be easily opened without significant effort.



GW86 SLIDING WINDOW

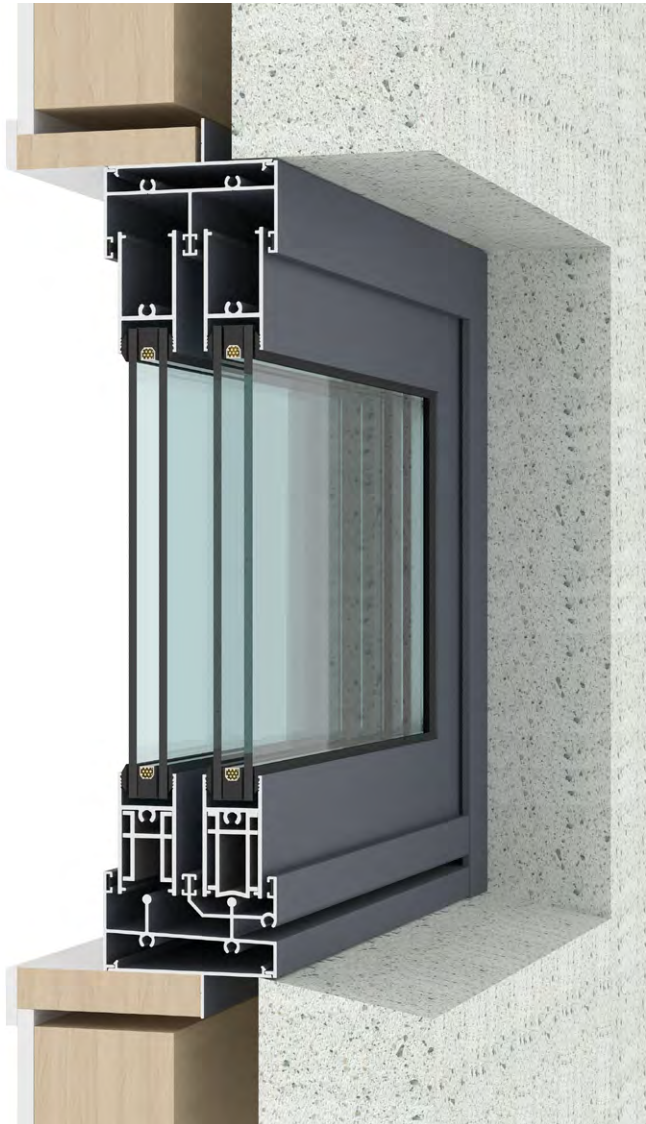

Standard: AS2047

Design SLS/ULS:600Pa/2000Pa

Design Water Resistance:200Pa

Sound Insulation:<36DB

WERS Data: Uw Range:3.5 - 6.4

SHGC Range:0.33 - 0.60



GW86 RESIDENTIAL SERIES

TECHNICAL SPECIFICATIONS

Available size:Max Height:1800mm

Max Window Panel width:1500mm

Maximum adaptive weight:80KG

Available glazing:Double Glazed:up to 22mm IGU

Frame dimension:Frame Depth: 85mm ;

Bottom frame Height:45mm

Extrusion Profiles:6063-T5 with 1.6mm Thickness

Powder Coating:AKZO-NOBLE Interpon Powder with 10 Years Warranty

Flynet:Fibreglass and Stainless Steel Security Mesh Available

Fixing Method:Sub sill/head /Fin fix / face fix /Timber reveal

Hardware:China Brand & Australia Doric Available

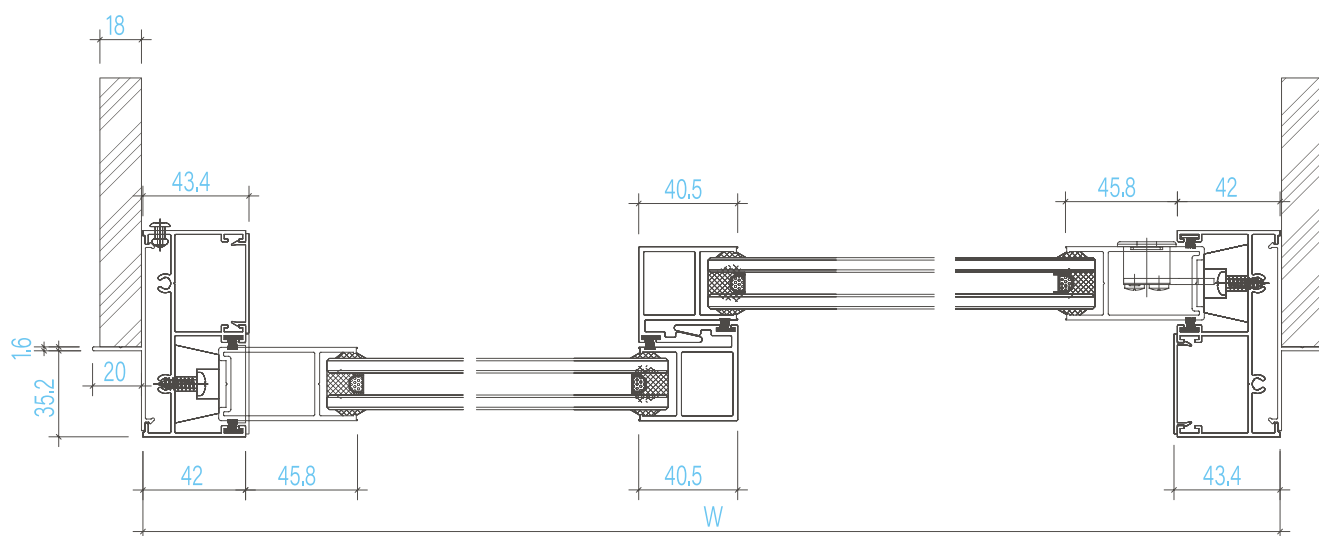
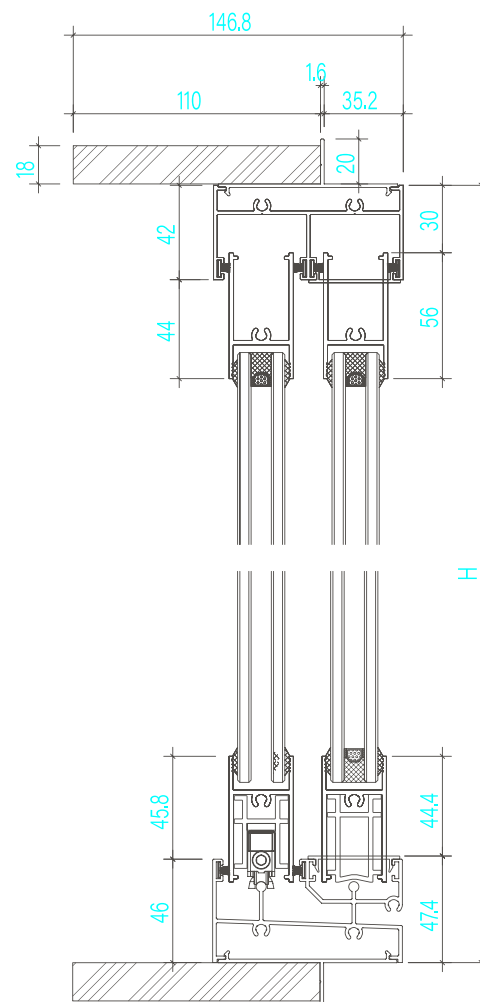



GW86 SLIDING WINDOW



Hardware Selections

① Brand: Doric

② Origin Country: Australia

③ Model: DS6005

④ Color: Black, Silver

Feature:

The DS6005 Avon Sliding window lock has a sleek contemporary design with a large, easy to grab handle.

Hardware Selections

① Brand: Doric

② Origin Country: Australia

③ Model: DN560

④ Color: Black, Silver

Feature:

The DN560 sliding window lock is the perfect compliment for windows that demand style.





GW86 RESIDENTIAL SERIES



GW86 AWNING WINDOW

As the awning window chain winder is located on the sill, these windows can be positioned higher up along the wall to limit anyone being able to see in, whilst still allowing in all the fresh air and natural light. Alternatively, if this type of window is used in a bathroom, using an obscure glass allows you to use this window for ventilation while still getting all the benefits of the privacy glass.



GW86 AWNING WINDOW



Standard: AS2047

Design SLS/ULS:1200Pa/4000Pa

WERS Data:Uw Range:4.6 - 6.9

Sound Insulation:<38DB

Design Water Resistance:450Pa

SHGC Range:0.28 - 0.46



GW86 RESIDENTIAL SERIES

TECHNICAL SPECIFICATIONS

Available size:Max Height:2100mm, Max Window Panel width:2100mm

Maximum adaptive weight:80KG

Available glazing:Double Glazed:up to 22mm IGU

Frame dimension:Frame Depth:85mm;Bottom frame Height:54mm

Extrusion Profiles:6063-T5 with 1.6mm Thickness

Powder Coating:AKZO-NOBLE Interpon Powder with 10 Years Warranty

Flynet:Fibreglass and Stainless Steel Security Mesh Available

Fixing Method:Sub sill / head / Fin fix / Timber reveal

Hardware:German Brand & Australia Doric Available

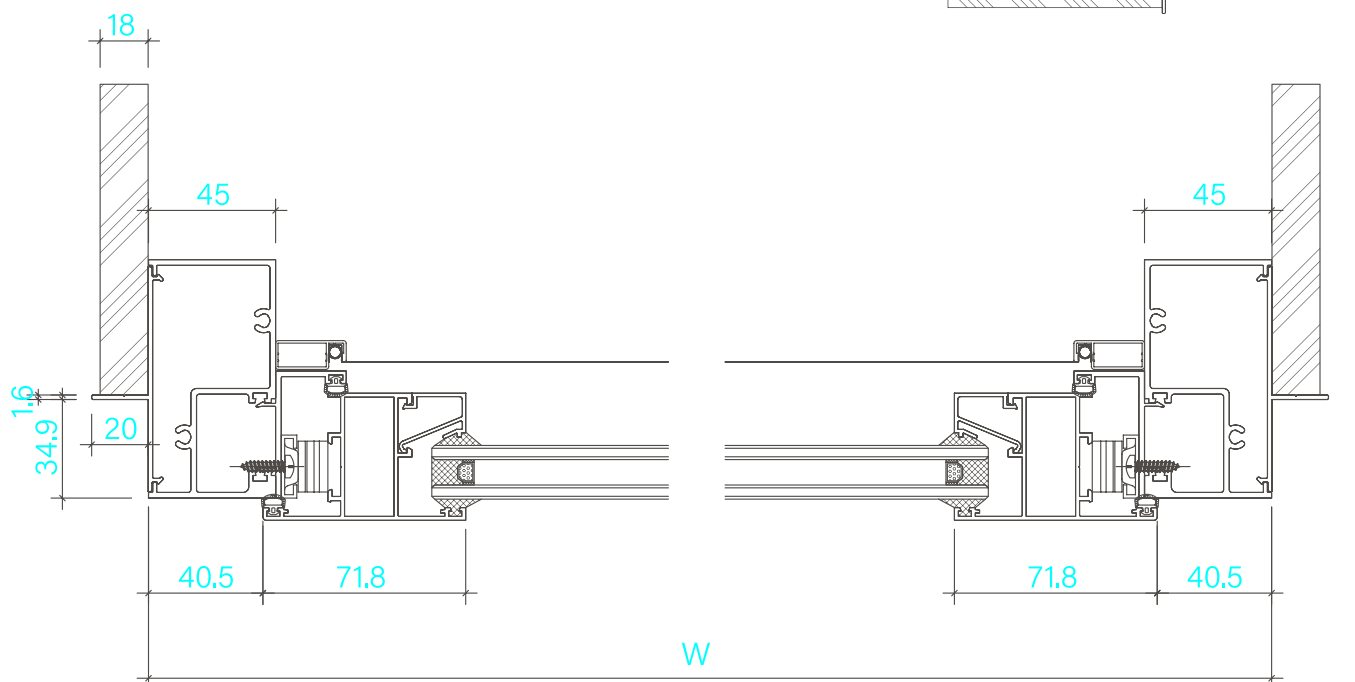



GW86 AWNING WINDOW



DS1 Chainwinder

① Brand: Doric

② Origin Country: Australia

③ Model: DS1

④ Color: Black, Silver

Feature:

Being the industry leader, the DS1 Chainwinder allows for easy operation and installation in a secure key lockable configuration.

DN400 Twin Chainwinder

① Brand: Doric

② Origin Country: Australia

③ Model: DN400

④ Color: Black, Silver

Feature:

The DN400 Twin Chainwinder can be pre-restricted in order to comply with the NCC and to meet the requirements of Kids Don't Fly.





GW86 RESIDENTIAL SERIES

GW86 FIXED WINDOW

Fixed window can help to keep your room warm in winter and cool in summer, making for effective energy saving and climate control.



GW86 FIXED WINDOW



Standard: AS2047

Design SLS/ULS:1200Pa/4000Pa

WERS Data: Uw Range:2.9~6.3

Sound Insulation:<38DB

Design Water Resistance:600Pa

SHGC Range:0.40 - 0.73



GW86 RESIDENTIAL SERIES

TECHNICAL SPECIFICATIONS

Available size:Max Height:2700mm,Max Window Panel width:2400mm

Maximum adaptive weight:200KG

Available glazing:Double Glazed:up to 22 IGU

Frame dimension:Frame Depth:85mm;Bottom frame Height:54mm

Extrusion Profiles:6063-T5 with 2.0mm Thickness

Powder Coating:AKZO-NOBLE Interpon Powder with 10 Years Warranty

Flynet:Fibreglass and Stainless Steel Security Mesh Available

Fixing Method:Sub sill / head / Fin fix / Timber reveal

Hardware:without

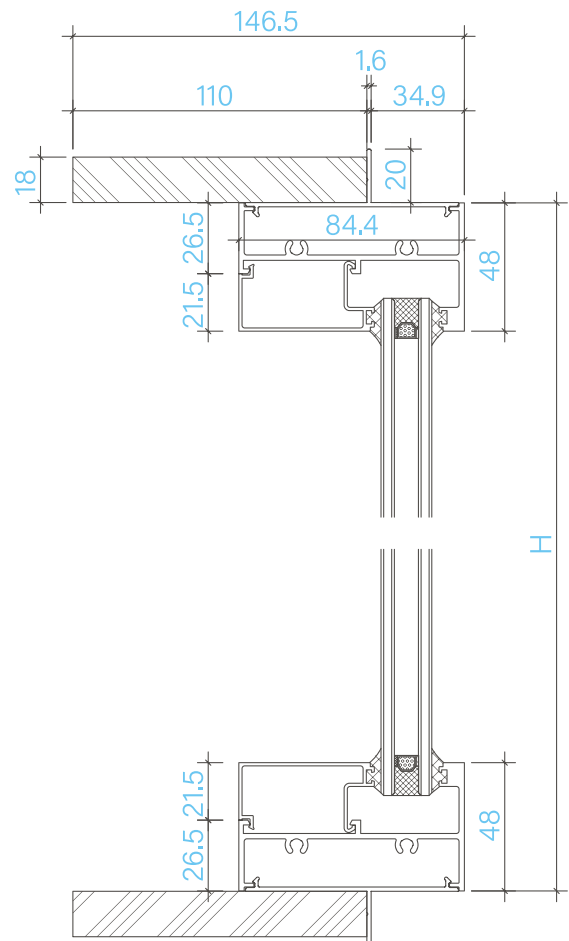



GW86 FIXED WINDOW





GW86 DOUBLE HUNG WINDOW

Aluminium double hung windows offer a simple aesthetic look that is ideal for a variety of different interior and exterior styles. The minimal design conceals a spring balance operating system and internal rivets. The vertical sliding of our aluminium double hung windows allows for effortless ventilation, with equally easy cleaning and low maintenance.



GW86 DOUBLE HUNG



Standard: AS2047

Design SLS/ULS:1000~3000pa

WERS Data: Uw Range:2.6~3.6

Sound Insulation:<38DB

Design Water Resistance:250pa

SHGC Range:0.32 - 0.65



GW86 RESIDENTIAL SERIES

TECHNICAL SPECIFICATIONS

Available size:Max Height:1000,Max Window Panel width:1200

Maximum adaptive weight:25KG

Available glazing:Double Glazed:up to 22mm IGU

Frame dimension:Frame Depth:83mm;Bottom frame Height:65mm

Extrusion Profiles:6063-T5 with 1.4mm Thickness

Powder Coating:AKZO-NOBLE Interpon Powder with 10 Years Warranty

Flynet:Fibreglass and Stainless Steel Security Mesh Available

Fixing Method:Sub sill / head / Fin fix / Timber reveal

Hardware:USA-Caldwell

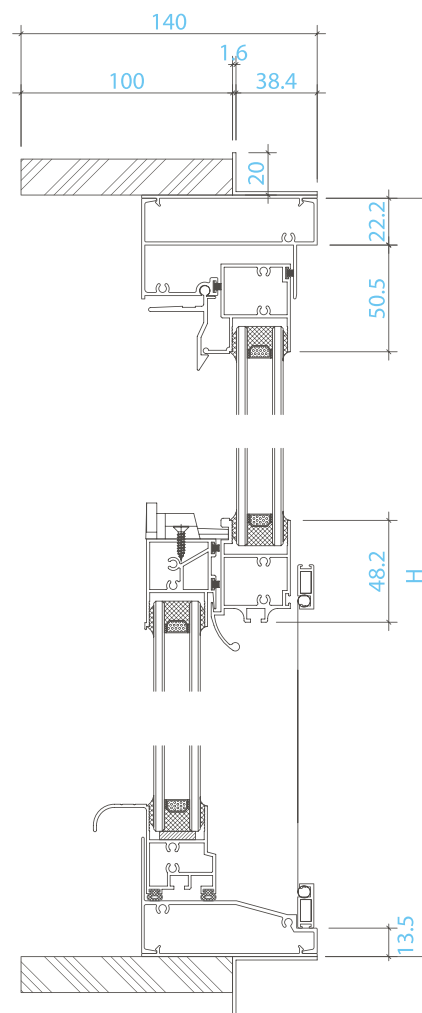



GW86 DOUBLE HUNG



Quick tilt application

① Brand: USA-Caldwell

② Origin Country: USA

③ Model: RS-TS02

④ Color: Black, White



Feature:

Pre assembled- reduce window assembly time Intergrated coil next and cover-Minimizes Contamination and Debris Robust drop in Cam-excellent structure performanceOptional friction adjuster-allows for easy field adjustment Optional Tamper lock-Limits Unintended Sash Removal

Commercial new construction

① Brand: USA-Caldwell

② Origin Country: USA

③ Model: RS-TS01

④ Color: Black, White

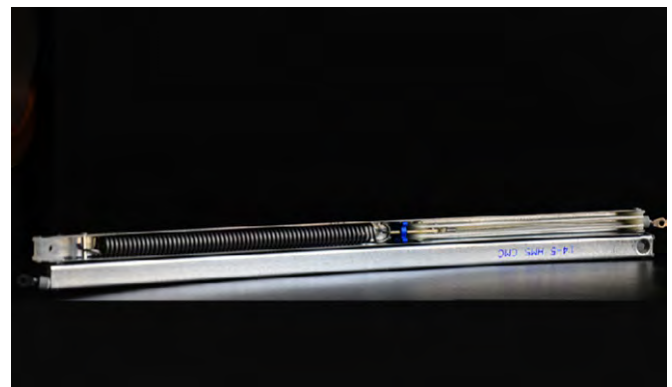

Feature:

High Lift Assistance-Make a heavy sash easy to operate Boosted force curve-Fits many common balance pockets AMAA Class 5 rating-balance lift 70% of sash weight Low carbon steel Rod-Rust resistance





GW86 GLASS LOUVRE

Glass louvre is the perfect addition to any living space, and with several glass options to choose from, you can ensure the perfect view. Durable and stylish, they strike a unique balance of effortless luxury.



GW86 GLASS LOUVRE



Standard: AS2047

Design SLS/ULS:400pa/1200pa

WERS Data: Uw Range:4.6~6.5

Sound Insulation:<28DB

Design Water Resistance:150pa

SHGC Range:0.45 - 0.76



GW86 RESIDENTIAL SERIES

TECHNICAL SPECIFICATIONS

Available size:Max Height:2700mm,Max Window Panel width:800mm

Maximum adaptive weight:10KG

Available glazing:Double Glazed:up to 6mm IGU

Frame dimension:Frame Depth:85mm;Bottom frame Height:45mm

Extrusion Profiles:6063-T5 with 2.0mm Thickness

Powder Coating:AKZO-NOBLE Interpon Powder with 10 Years Warranty

Flynet:Fibreglass and Stainless Steel Security Mesh Available

Fixing Method:Sub sill / head / Fin fix / Timber reveal

Hardware:CHN-MTEN

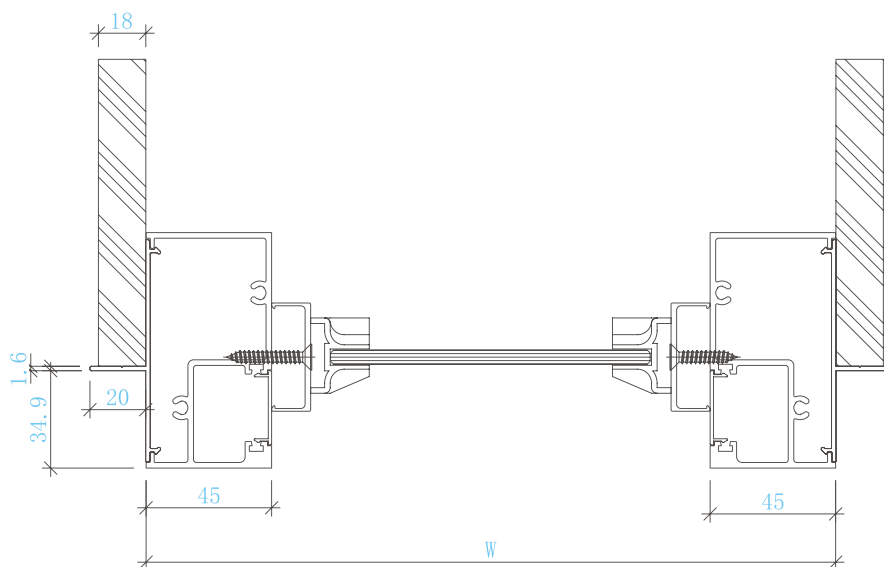
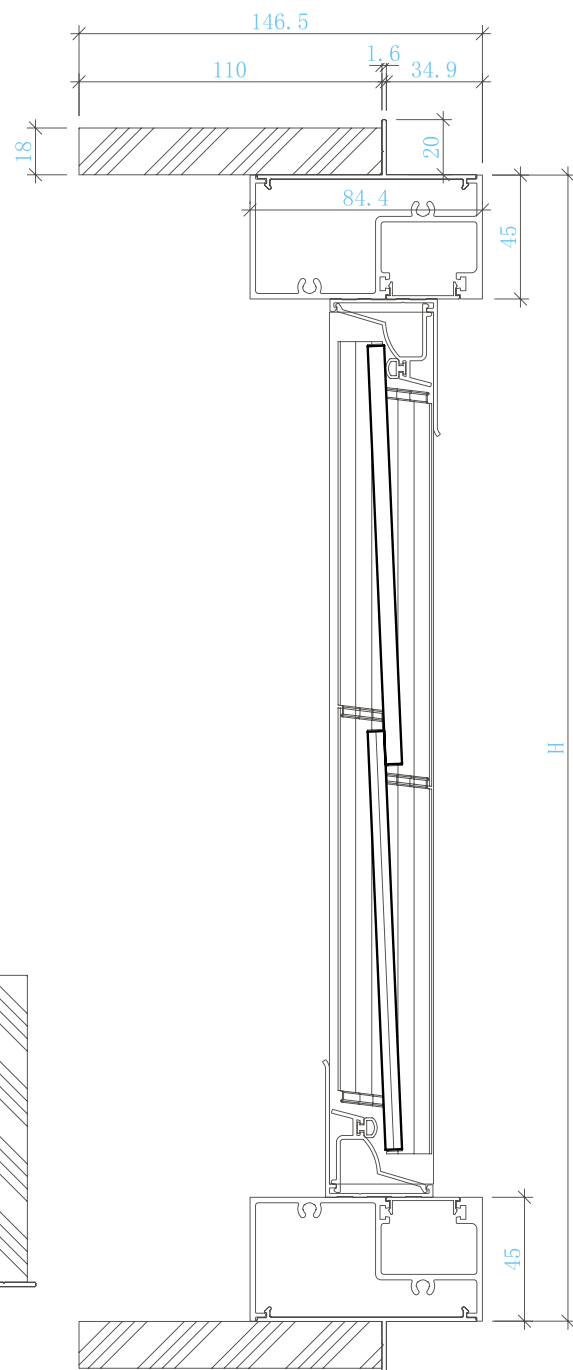



GW86 GLASS LOUVRE



RS Louvre Galleries

① Brand: China Brand

② Origin Country: China

③ Model: 6ALPP24

④ Color: Black, white

Feature:

Louvres are the ideal window solution to creating an open functional living environment. Vent, the 100% Opening Advantage Ergonomic handle design Non-Scratch UV-stabilised powder coat



GW86 RESIDENTIAL SERIES



GW86 SLIDING DOOR

Sliding door open horizontally, and are held up by wheels or suspended on a track, unlike standard doors which are suspended on hinges and open by turning. Sliding doors are commonly used for bathrooms and for external doors made of glass. Sliding doors save space, allow maximum light, and can create an open and spacious appearance.



GW86 SLIDING DOOR



Standard: AS2047

Design SLS/ULS:600Pa/1400Pa

WERS Data: Uw Range:3.0 - 3.8

Sound Insulation:<36DB

Design Water Resistance:200pa

SHGC Range:0.33 - 0.59



GW86 RESIDENTIAL SERIES

TECHNICAL SPECIFICATIONS

Available size:Max Height:2700mm,Max Window Panel width:1200mm

Maximum adaptive weight:150KG

Available glazing:Double Glazed:up to 22mm IGU

Frame dimension:Frame Depth:85mm;Bottom frame Height:45mm

Extrusion Profiles:6063-T5 with 2.0mm Thickness

Powder Coating:AKZO-NOBLE Interpon Powder with 10 Years Warranty

Flynet:Fibreglass and Stainless Steel Security Mesh Available

Fixing Method:Sub sill / head / Fin fix / Timber reveal

Hardware:China Brand & Australia Doric Available

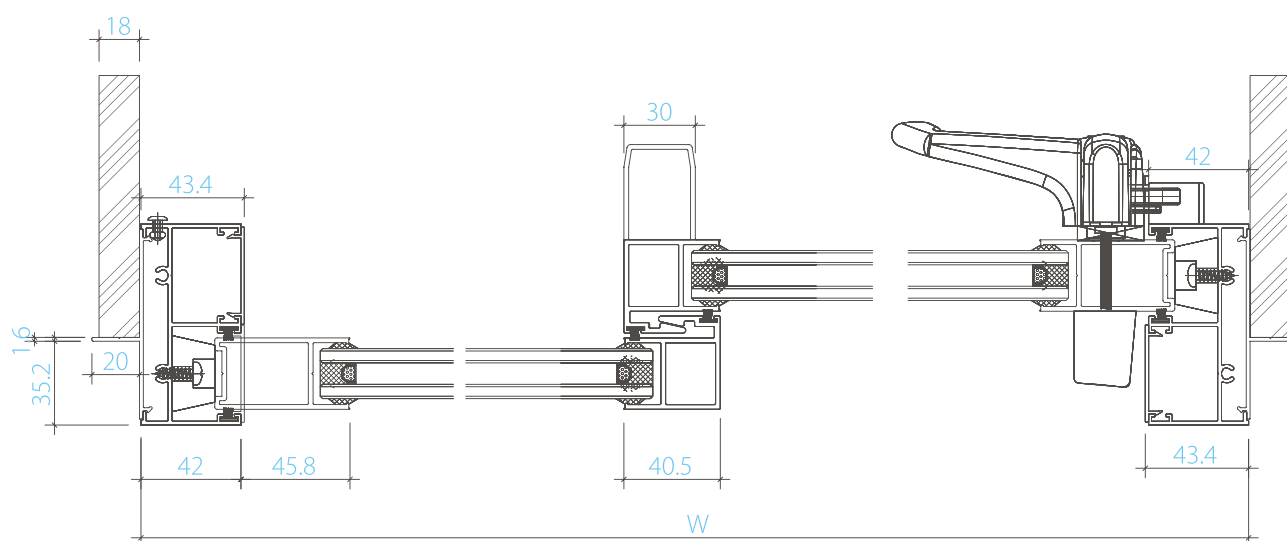
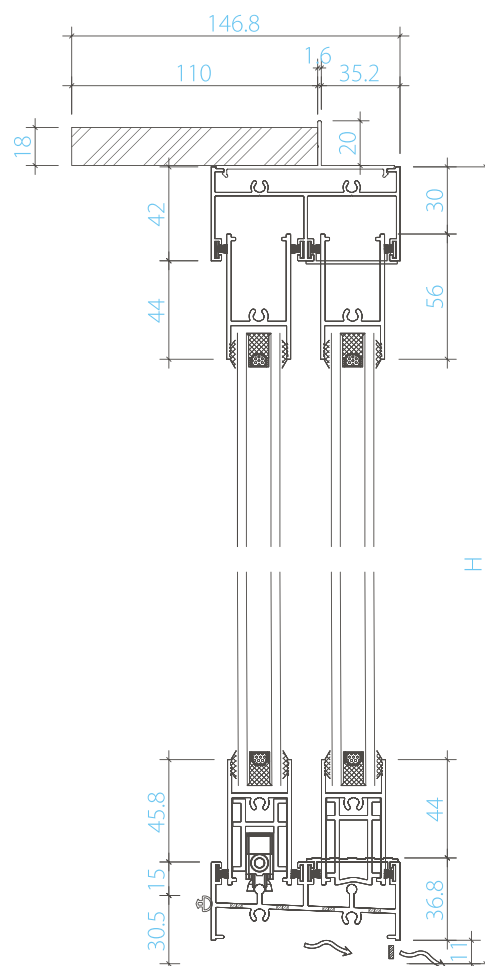



GW86 SLIDING DOOR



DS3130 Sliding Door Lock

① Brand:Doric

② Origin Country:Australia

③ Model:DS3130

④ Color:Black, Silver

Feature:

The DS3130 Timbarra Twin Sliding Patio Door Lock was the first non-handed twin actuator system to be offered in the Australian market.

DS930 Sliding Door Lock

① Brand:Doric

② Origin Country:Australia

③ Model:DS930

④ Color:Black, Silver

Feature:

The DS930 handle range has the flexibility for various configurations and handle shapes. The patio door furniture features simple snib operation as well as a clean and contemporary aesthetic, ideal for apartment and residential application.





GW68 RESIDENTIAL SERIES



GW68 BIFOLDING DOOR

Aluminum bifolding doors are more than just stylish – they are manufactured to last and provide durable performance. Their minimalist design aesthetic create a seamless statement in a variety of spaces, while the folding functionality opens up the possibilities to perfectly complement alfresco style dining or entertaining areas.



GW68 BIFOLDING DOOR



Standard: AS2047

Design SLS/ULS:800Pa/2000Pa

WERS Data:Uw Range:3.0 ~ 4.2

Sound Insulation:<36DB

Design Water Resistance:200pa

SHGC Range:0.36 - 0.52



GW68 RESIDENTIAL SERIES

TECHNICAL SPECIFICATIONS

Available size:Max Height:3000mm,Max Window Panel width:850mm

Maximum adaptive weight:150KG

Available glazing:Double Glazed:up to 32mm IGU

Frame dimension:Frame Depth:77.3mm;Bottom frame Height:53mm

Extrusion Profiles:6063-T5 with 2.0mm Thickness

Powder Coating:AKZO-NOBLE Interpon Powder with 10 Years Warranty

Flynet:Fibreglass and Stainless Steel Security Mesh Available

Fixing Method:Fin fix

Hardware:CHN- KSBG

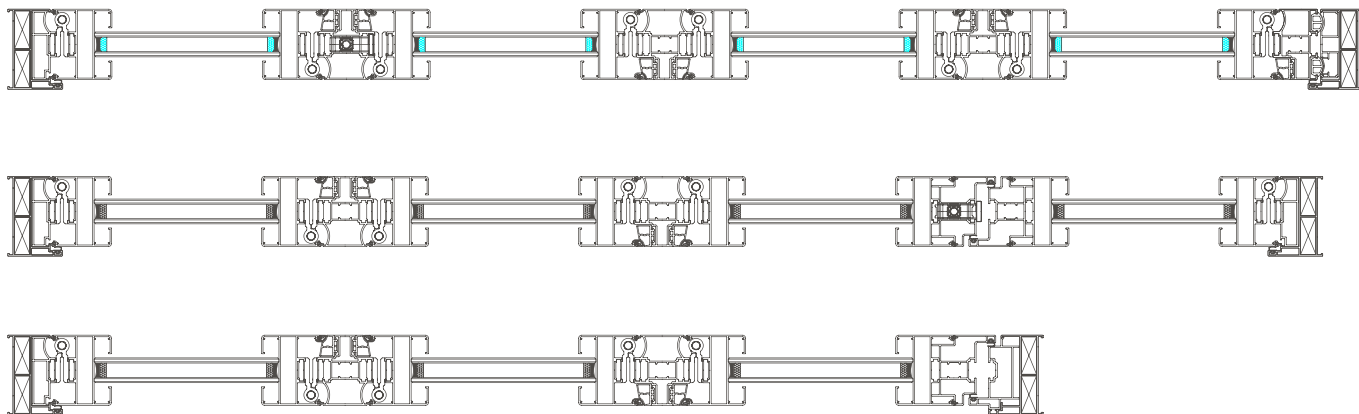
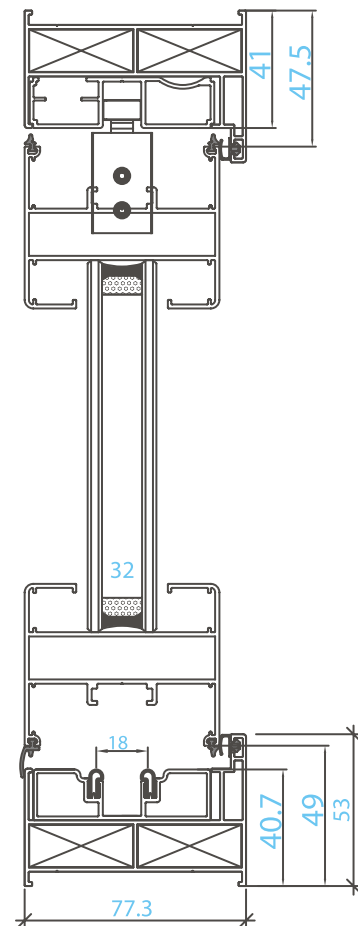



GW68 BIFOLDING DOOR



Bifolding Door

① Brand: China Brand KSBG

② Origin Country: China

③ Model: KSBG-80

④ Color: Silver, Black

Feature:

automatic lock function Hardware hidden design satisfy any combination of folds Corner design with wide vision



FLYSCREEN SELECTIONS

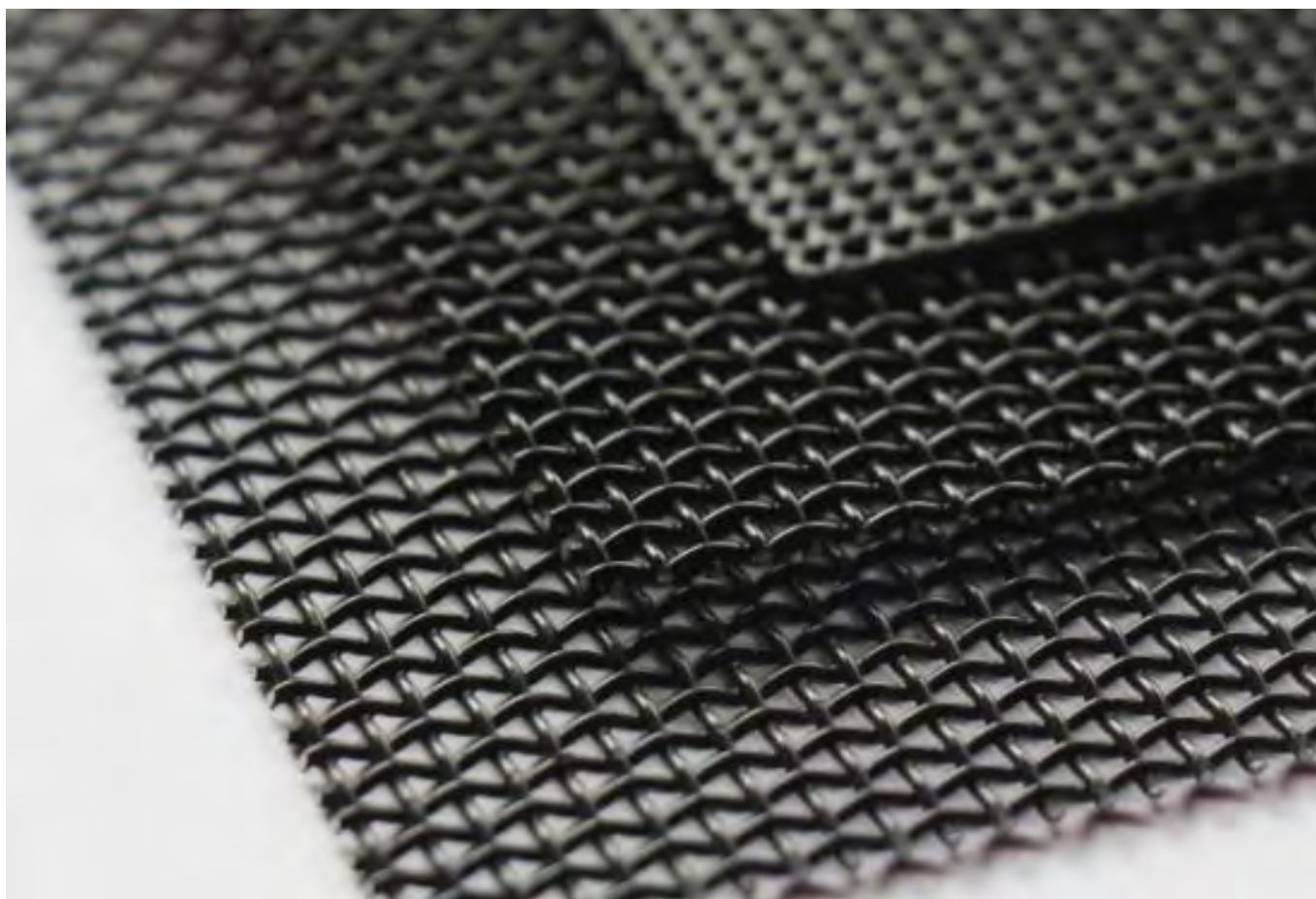

0811 Security Screen

① Material: SUS304	② Finishing: Powder coating	③ Thickness: 0.8mm
④ Weave: 11/cm ²	⑤ Color: Black, Grey	

0514 Security Screen

① Material: SUS304	② Finishing: Powder coating	③ Thickness: 0.5mm
④ Weave: 11/cm ²	⑤ Color: Black, Grey	

0218 Security Screen

① Material: SUS304	② Finishing: Powder coating	③ Thickness: 0.185mm
④ Weave: 18/cm ²	⑤ Color: Black Only.	

1511 Pet screen

① Material: 30% fabric, 70%PVC coating		② Finishing: Powder coating
④ Mesh: 360g/m ²	⑤ Weave: 15*11 /inch	⑥ Color: Black



GLASS SELECTIONS

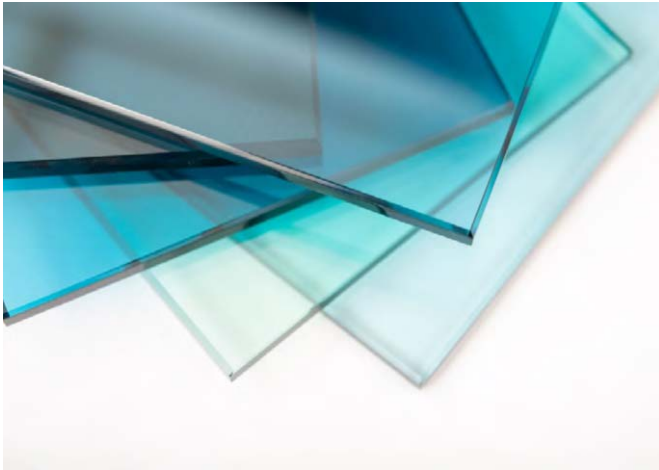

Single Glass

- ① Thickness: 5mm/6mm/8mm/10mm/12mm
 - ② Treatment: tempered, Heat soaked thermally tempered
 - ③ Color: Ultra Clear, Clear, Obscure, tint
 - ④ Finishing: Reflective, Spendral
- Feature: Safe, Strength wind pressure, high impact resistance

Laminated Glass

- ① Thickness: 8.76mm/10.76mm/11.14mm/12.76mm/13.14mm
- ② Treatment: tempered, Heat soaked thermally tempered
- ③ vinyl interlayer : PVB
- ④ Interlayer thickness: 0.38mm/0.76mm/1.14mm
- ⑤ Color: Ultra Clear, Clear, Obscure, tint
- ⑥ Finishing: Reflective, Spendral

Feature: Safe, Strength wind pressure, high impact resistance, reduce noise.

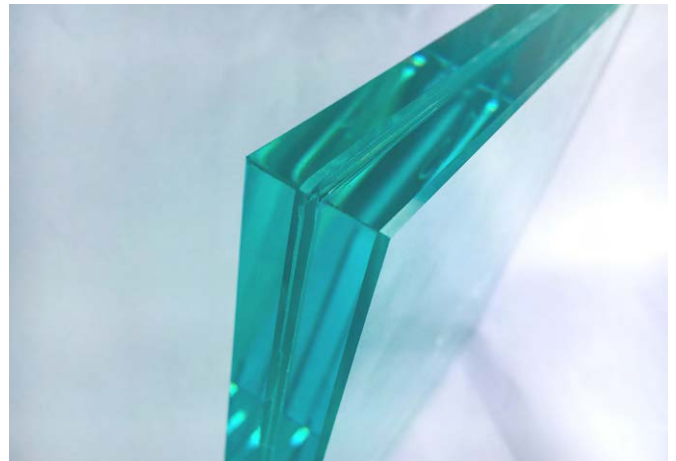

Double Glass

- ① Thickness: 6mm+12A+6mm/6mm+12A+8.76mm /6mm+9A+10.76mm
- ② Glass spacer color: Silver/black
- ③ Gas: Air/Argon
- ④ Treatment: tempered, Heat soaked thermally tempered
- ⑤ Color: Ultra Clear, Clear, Obscure, tint
- ⑥ Finishing: Reflective, Spendral

Feature: Safe, Strength wind pressure, high impact resistance, reduce noise, energy efficiency



FIXING METHOD



Sub Head, Sub Sill, Angle

Features: High water leakage resistance, simple installation (saving labor), safety, fast delivery

Wall structure suitable:

Concrete structure

Light Gauge and Hebel Structure

Double Brick Structure

Light Gauge and Brick Structure

Application: Commercial Buildings, Apartment, Townhouse, Dwellings

(Not applicable to series 50)



Sub Head



Sub Sill



Angle



Sub Head, Sub Sill, Sub Frame

Features: High water leakage resistance, simple installation (saving labor), safety, fast delivery

Wall structure suitable:

Concrete structure

Light Gauge and Hebel Structure

Double Brick Structure

Light Gauge and Brick Structure

Application: Commercial Buildings, Apartment, Townhouse, Dwellings

(Not applicable to series 50)



Sub Head



Sub Sill



Sub JOMB



FIXING METHOD



40mm Fin

Features: high water leakage resistance, simple and fast installation and safety;

Wall structure suitable:
Timber Stud and 100/150mm Hebel Structure
Brick Veneer Structure
Light Gauge and Brick Structure

Application: Townhouse, Dwellings

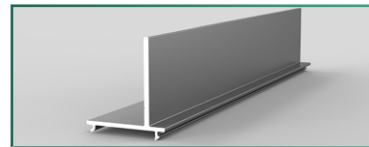

40mm Fin



Timber reveal + Dampcourse

Features: high water leakage resistance, simple and fast installation and safety;

Wall structure suitable:
Timber Stud and 100/150mm Hebel Structure
Brick Veneer Structure
Light Gauge and Brick Structure

Application: Townhouse, Dwellings



Timber reveal



FINISHING:POWDER COATING

Standard Color

Standard Color: Black/Monument/Grey/White

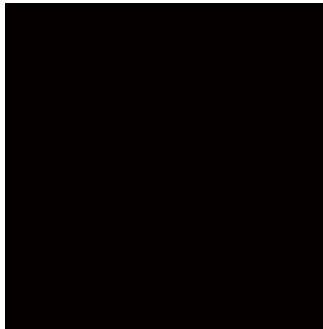

Matt Black-LL0369

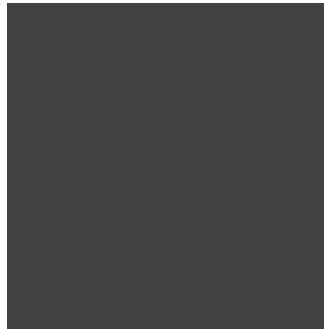

Matt Monument-LL0363

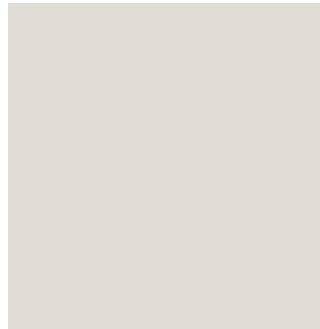

Light Grey-LL0365

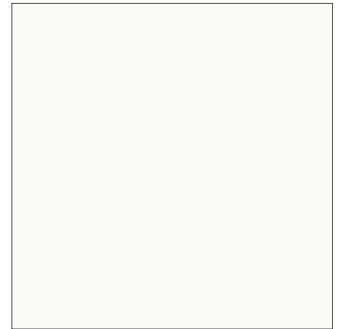

Matt White-LL0364

Custom color



- ① Brand: Interpon
- ② Customized color: Color bond or RAL swatches
- ③ 10 years warranty Higher resistance products available either.

Features Safe, clean, economical and eco-friendly excellent performance
Meet the wide range of global coatings standards.



OUR SUPPLIERS



We are proud of having built a long term cooperation with the partners above. We are really appreciative of them giving us comprehensive advice so that we can make quality products and provide professional service for our clients. Better products will be created through the efforts from our partners, the clients and GW team.



GW WINDOWS ORDERING FLOWS

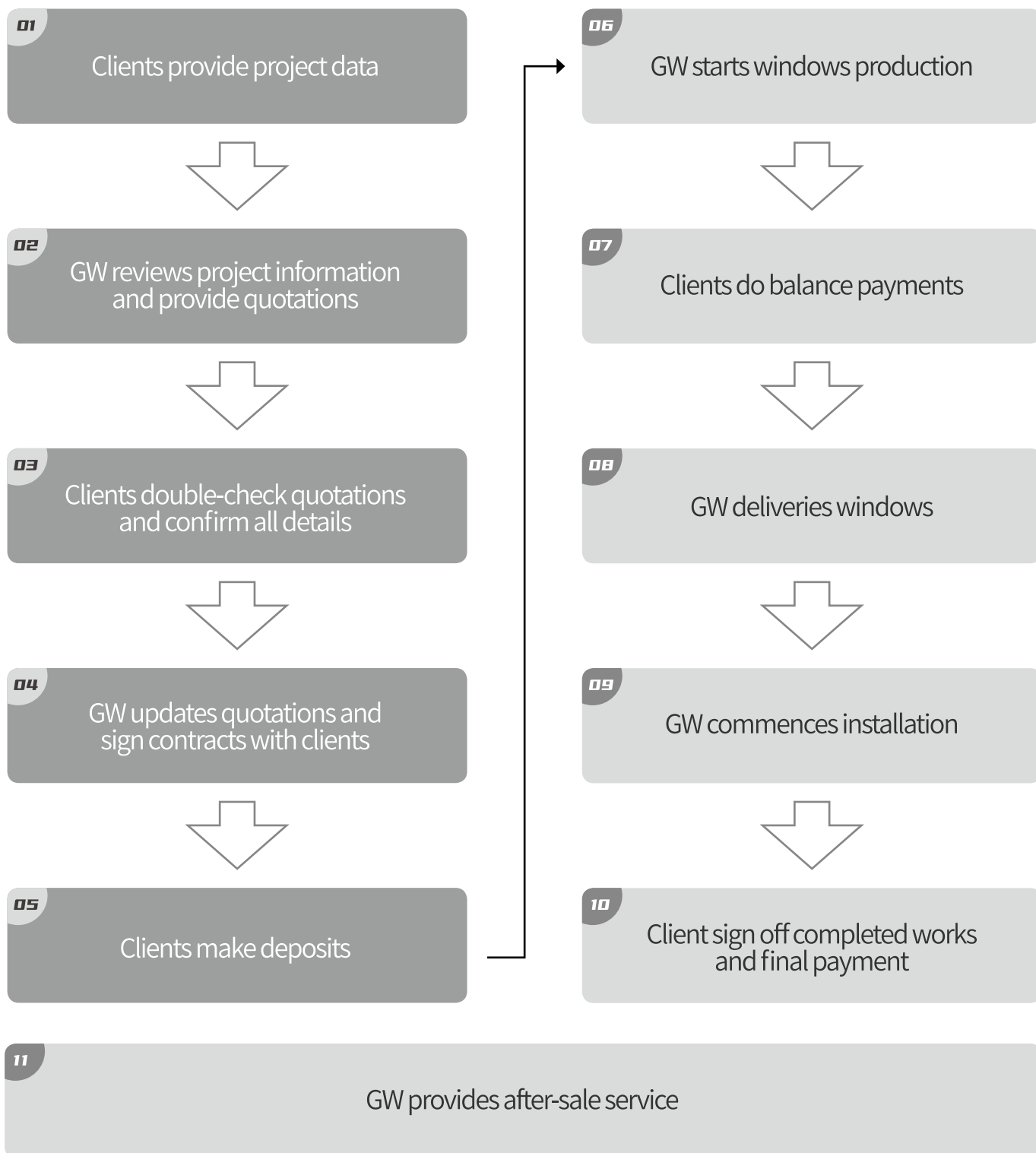



PROJECTS COLLECTION



FOLLOW US



Contact Number :

0416 223 886 (Carol)

0422 040 050 (Le)

Email: info@gatewisemetals.com.au

Web: gatewisemetals.com.au

MANUFACTURER:

Gatewise Metals Pty Ltd

Showroom & Factory

8 Pat Devlin Close Chipping Norton NSW 2170



Facebook



Instagram